



ARC Series | Welding robots Model: SF6-C2080X

The ARC is your most vital partner in the field of industrial arc welding, with the innovative technology of the Hollow Wrist, which ensures extremely short motion cycles and the highest precision trajectory.

The ARC is capable of working at extremely high trajectory accuracy and speed, with convincingly higher accuracy and better performance, easy maintenance features to minimize follow-up costs.

The ARC has the better performance and higher power density for arc welding, cutting, handling, machine loading and unloading, picking /packing, and assembly/disassembly.

The equipment performs efficiently and stably at long and short distances through acceleration and deceleration switching technology. Higher efficiency and economic benefits are achieved with a maximum speed of over 700 °/s due to fine grading and higher core computing.

Applications

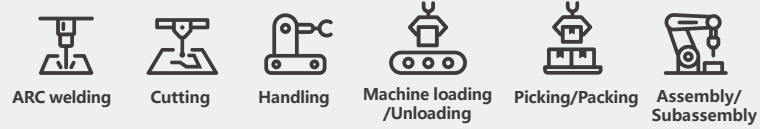

SF6-C2080X Data Overview

Model	SF8-C2080X	
Structure	Vertically Articulated	
Number of Axis	6	
Radius	2008mm	
Payload	6kg	
Repeatability	±0.08mm	
Drive Mode	AC Servo Motor	
Maximum Speed	J1	190°/s
	J2	190°/s
	J3	190°/s
	J4	400°/s
	J5	400°/s
	J6	700°/s
Range of Motion	J1	±170°
	J2	+100°/-157°
	J3	+90°/-80°
	J4	±155°
	J5	+134°/-137°
	J6	±220°
Allowable Moment	J4	10N·m
	J5	10N·m
	J6	5.5N·m
Allowable Inertia	J4	0.28kg·m ²
	J5	0.28kg·m ²
	J6	0.06kg·m ²
Protection Rating	IP 65	
Operating Conditions	Temp.	0-45°C
	Humidity	Below 95%RH
	Vibration	Below 4.9m/s ²
	Other	Eliminate Signal Noise
Base Size	396*396mm	
Height	1640mm	
Weight	280KG	
Mounting Positions	Floor, Wall, Ceiling	
Power Consumption	3.8kVA	

SF6-C2080X Range of Motion

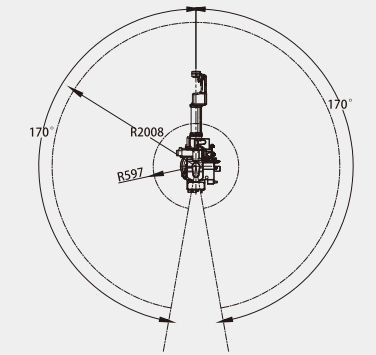
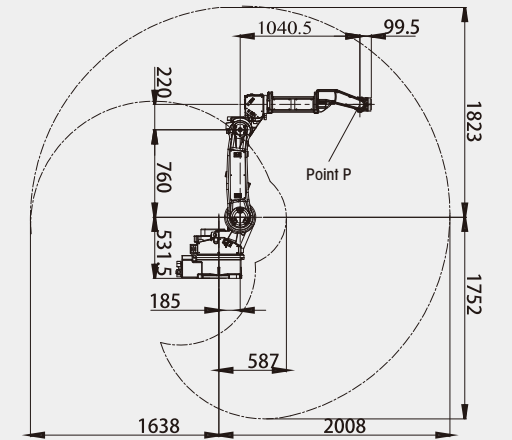

SF6 - C2080X Wrist Load Curve Chart

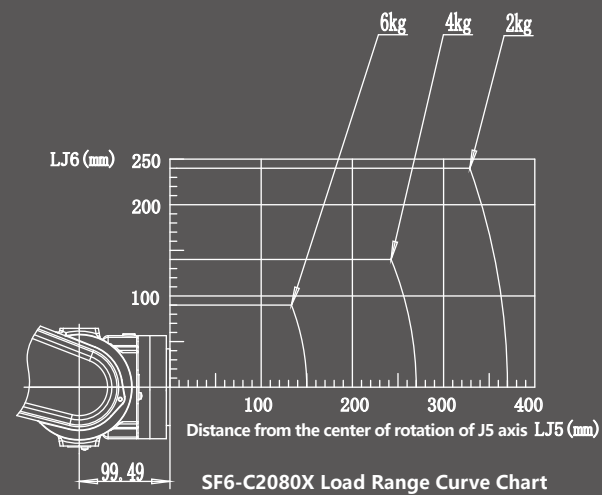

SF6-C2080X External & Installation Dimensions

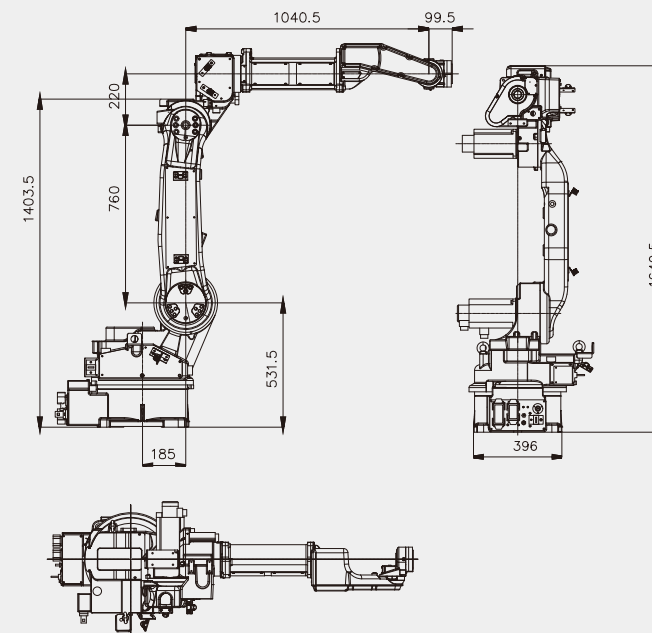

A-Way Diagram (End Flange Mounting Dimensions)

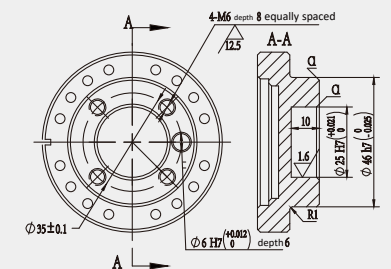

B-Way Diagram (Base Mounting Dimensions)

