



MIMETIC Series | Medium duty robot
Model: SF50 - K2178

The MIMETIC is a medium payload industrial robot with a superior working range, advanced servo control technology, and an extremely rigid arm, significantly reducing cycle times and ensuring high productivity.

MIMETIC is a complete solution for medium payload class industrial robots to secure your future planning and production investment. From 20 kg up to 120 kg of fine load breakdown.

It is the perfect solution to ensure accuracy and production quality. Whether handling, machine loading/unloading, painting, stamping, palletizing, grinding, picking/packing, or assembly/distribution. In addition, you will have the freedom to choose the robot corresponding to your actual needs for greater efficiency and economic benefits.

All MIMETIC series are equipped with LIKEPRECISION technology, the ultra-precise RV Precision Gearbox, which enables the robot to take full advantage of its advantages even at high operating speeds.

Applications



SF50 - K2178 Data Overview

Model	SF50 - K2178	
Structure	Vertically Articulated	
Number of Axis	6	
Radius	2178mm	
Payload	50kg	
Repeatability	±0.08mm	
Drive Mode	AC Servo Motor	
Maximum Speed	J1	125°/s
	J2	125°/s
	J3	140°/s
	J4	200°/s
	J5	210°/s
	J6	290°/s
Range of Motion	J1	±172°
	J2	+72°/-140°
	J3	+175°/-80°
	J4	±360°
	J5	±116°
	J6	±360°
Allowable Moment	J4	185N·m
	J5	185N·m
	J6	126N·m
Allowable Inertia	J4	12kg·m ²
	J5	12kg·m ²
	J6	9.6kg·m ²
Protection Rating	IP 65	
Operating Conditions	Temp.	0-45°C
	Humidity	Below 95%RH
	Vibration	Below 4.9m/s ²
	Other	Eliminate Signal Noise
Base Size	573*629mm	
Height	1778mm	
Weight	610KG	
Mounting Positions	Floor, Wall, Ceiling	
Power Consumption	5kVA	

SF50 - K2178 Range of Motion

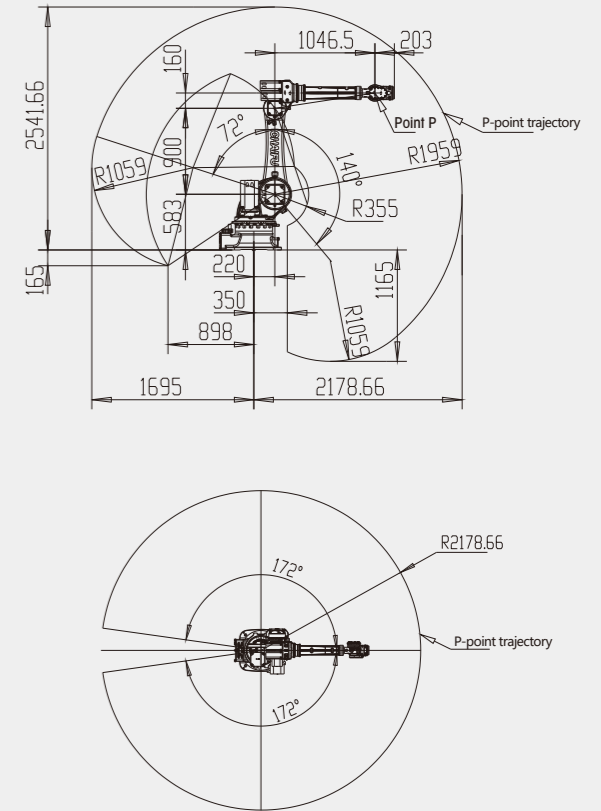

SF50 - K2178 Wrist Load Curve Chart

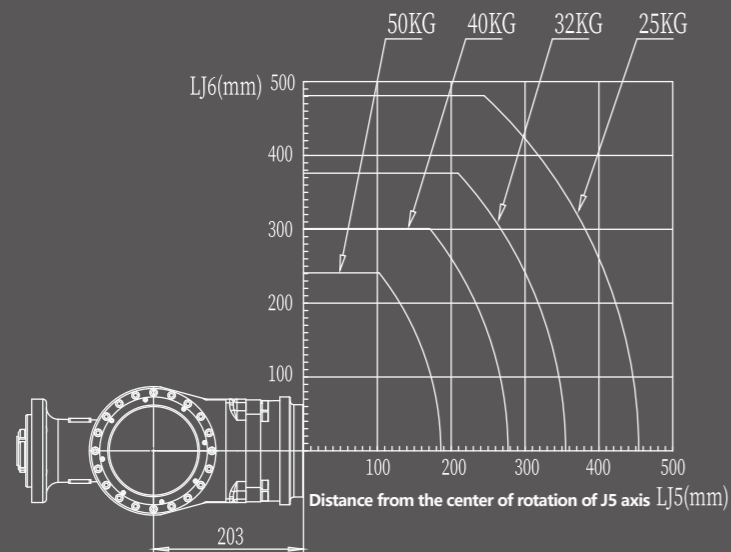

SF50 - K2178 Load Range Curve Chart

SF50 - K2178 External & Installation Dimensions

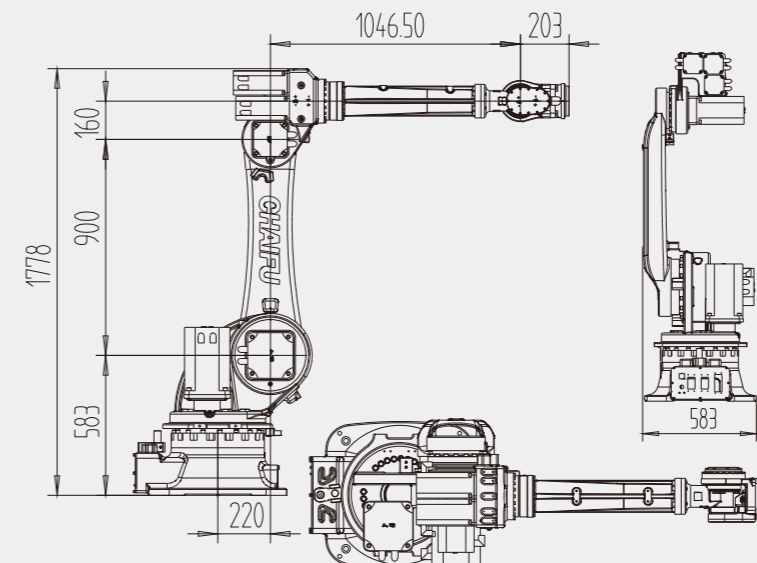

A-Way Diagram (End Flange Mounting Dimensions)

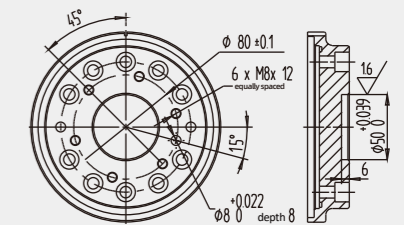

B-Way Diagram (Base Mounting Dimensions)

